

CAPSULE SLIP RINGS

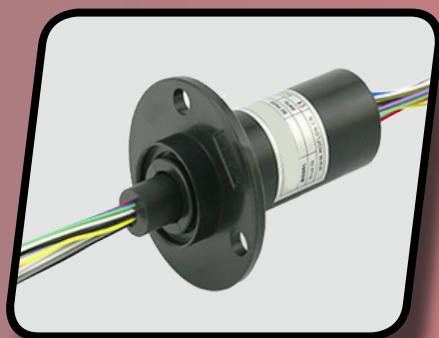
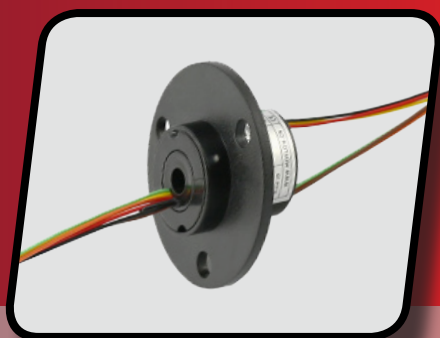

CTC SERIES

V2.2.11

DRAWINGS

CTC005S-00P/XS

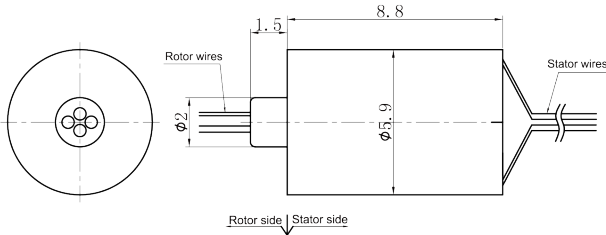

CTC005S-00P/XS
CTC006S-00P/XS

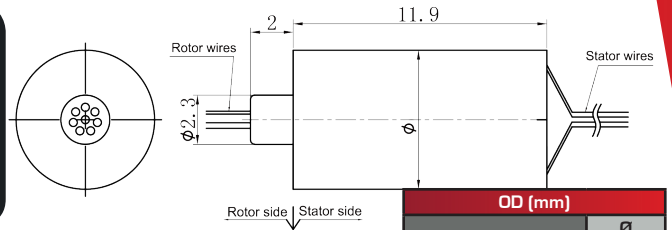

OD (mm)	
	Ø
CTC005S-00P/02S	5,9
CTC006S-00P/04S	6,5

CTC011S-00P/XS

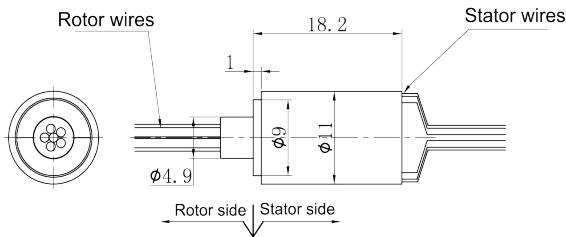

CTC012S-00P/XS

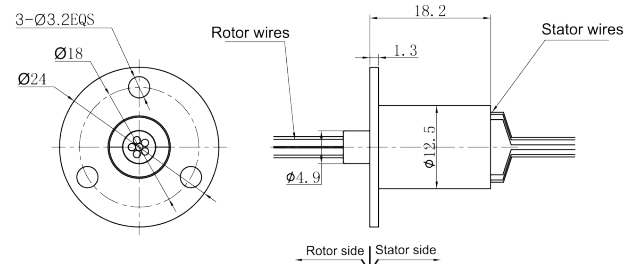

CTC012S-00P/XS

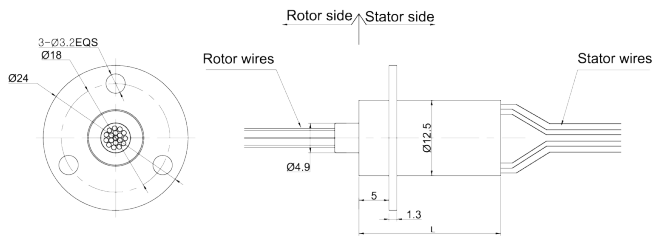

LENGTH (mm)	
	L
CTC012S-00P/12S	19,5
CTC012S-00P/18S	23,5

CTC015S-00P/XS

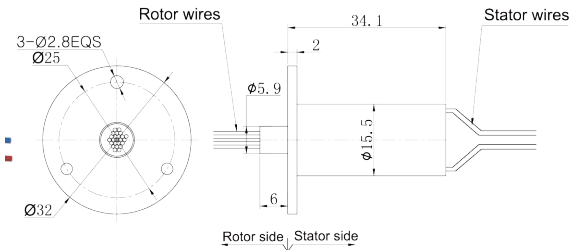

CTC022S-00P/XS

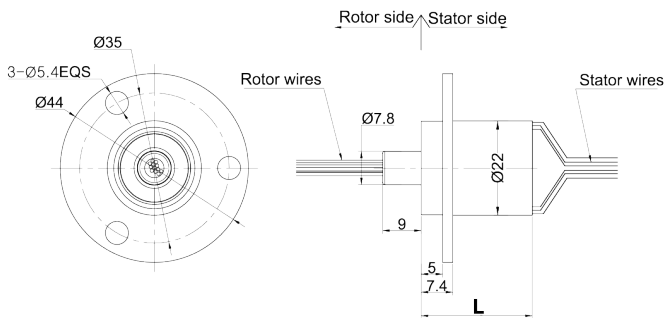

LENGTH (mm)	
	L
CTC022S-00P/06S	19
CTC022S-00P/12S	26
CTC022S-00P/18S	33
CTC022S-00P/36S	57,3

CTC022S-00P/XS

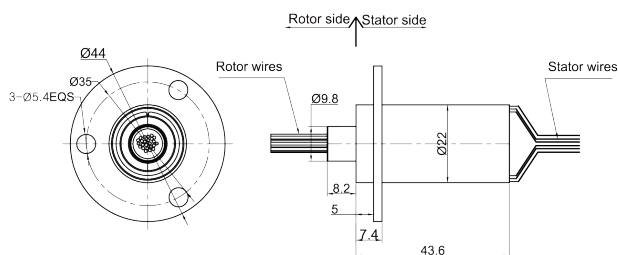

CTC025S-00P/XS

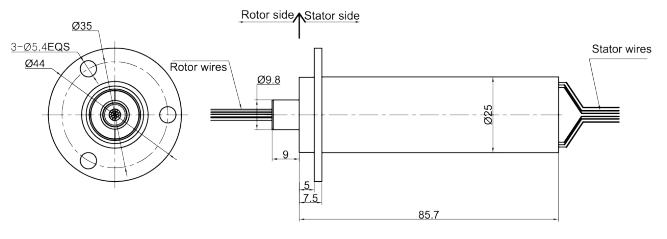

TECHNICAL DATA

Model	Length	OD	Circuits						Total Wires	Max Working speed (rpm)		Working life (cycles)		Electrical Noise @10rpm (mΩ)		Housing material	
			Signal					S		I	S	I	S	I	S	I	
			1A	2A	4A	8A	15A										
CTC005	CTC005S-00P/02S	8,8	5,9	2	-	-	-	-	2	250	1000	1e ⁰⁷	3e ⁰⁷	10	4	ABS	ABS
	CTC005S-00P/04S	8,8	5,9	4	-	-	-	-	4	250	1000	1e ⁰⁷	3e ⁰⁷	10	4	ABS	ABS
	CTC005S-00P/02S	11,9	5,9	2	-	-	-	-	2	250	1000	1e ⁰⁷	3e ⁰⁷	10	4	ABS	ABS
	CTC005S-00P/04S	11,9	5,9	4	-	-	-	-	4	250	1000	1e ⁰⁷	3e ⁰⁷	10	4	ABS	ABS
	CTC005S-00P/06S	11,9	5,9	6	-	-	-	-	6	250	1000	1e ⁰⁷	3e ⁰⁷	10	4	ABS	ABS
	CTC005S-00P/08S	11,9	5,9	8	-	-	-	-	8	250	1000	1e ⁰⁷	3e ⁰⁷	10	4	ABS	ABS
CTC006 CTC011	CTC006S-00P/04S	11,9	6,5	4	-	-	-	-	4	250	1000	1e ⁰⁷	3e ⁰⁷	10	4	ABS	ABS
	CTC006S-00P/06S	11,9	6,5	6	-	-	-	-	6	250	1000	1e ⁰⁷	3e ⁰⁷	10	4	ABS	ABS
	CTC006S-00P/08S	11,9	6,5	8	-	-	-	-	8	250	1000	1e ⁰⁷	3e ⁰⁷	10	4	ABS	ABS
CTC012 CTC015	CTC011S-00P/06S	18,2	11	6	-	-	-	-	6	250	1000	1e ⁰⁷	3e ⁰⁷	10	4	ABS	ABS
	CTC012S-00P/06S	18,2	12,5	-	6	-	-	-	6	250	1000	1e ⁰⁷	3e ⁰⁷	10	4	ABS	ABS
	CTC012S-00P/12S	19,5	12,5	12	-	-	-	-	12	250	1000	1e ⁰⁷	3e ⁰⁷	10	4	ABS	ABS
CTC022 CTC025	CTC015S-00P/24S	23,5	12,5	18	-	-	-	-	18	250	1000	1e ⁰⁷	3e ⁰⁷	10	4	ABS	ABS
	CTC022S-03P/00S	19	22	-	-	3	-	-	3	250	1000	4e ⁰⁷	15e ⁰⁷	10	4	ABS	Metal
	CTC022S-01P/02S	19	22	2	-	1	-	-	3	250	1000	4e ⁰⁷	15e ⁰⁷	10	4	ABS	Metal
	CTC022S-02P/02S	19	22	2	2	-	-	-	4	250	1000	4e ⁰⁷	15e ⁰⁷	10	4	ABS	Metal
	CTC022S-00P/06S	19	22	6	-	-	-	-	6	250	1000	4e ⁰⁷	15e ⁰⁷	10	4	ABS	Metal
	CTC022S-03P/00S	26	22	-	-	3	-	-	3	250	1000	4e ⁰⁷	15e ⁰⁷	10	4	ABS	Metal
	CTC022S-02P/02S	26	22	2	-	2	-	-	4	250	1000	4e ⁰⁷	15e ⁰⁷	10	4	ABS	Metal
	CTC022S-03P/06S	26	22	6	3	-	-	-	9	250	1000	4e ⁰⁷	15e ⁰⁷	10	4	ABS	Metal
	CTC022S-00P/12S	26	22	12	-	-	-	-	12	250	1000	4e ⁰⁷	15e ⁰⁷	10	4	ABS	Metal
	CTC022S-02P/00S	33	22	-	-	-	-	2	2	250	1000	4e ⁰⁷	15e ⁰⁷	10	4	ABS	Metal
	CTC022S-04P/02S	33	22	2	-	4	-	-	6	250	1000	4e ⁰⁷	15e ⁰⁷	10	4	ABS	Metal
	CTC022S-03P/06S	33	22	6	-	3	-	-	9	250	1000	4e ⁰⁷	15e ⁰⁷	10	4	ABS	Metal
	CTC022S-06P/06S	33	22	6	6	-	-	-	12	250	1000	4e ⁰⁷	15e ⁰⁷	10	4	ABS	Metal
	CTC022S-00P/18S	33	22	18	-	-	-	-	18	250	1000	4e ⁰⁷	15e ⁰⁷	10	4	ABS	Metal
	CTC022S-03P/00S	43,6	22	-	-	-	-	3	3	250	1000	2e ⁰⁷	10e ⁰⁷	10	4	ABS	Metal
	CTC022S-05P/00S	43,6	22	-	-	5	-	-	5	250	1000	2e ⁰⁷	10e ⁰⁷	10	4	ABS	Metal
	CTC022S-04P/04S	43,6	22	4	-	4	-	-	8	250	1000	2e ⁰⁷	10e ⁰⁷	10	4	ABS	Metal
	CTC022S-02P/06S	43,6	22	6	-	-	-	2	8	250	1000	2e ⁰⁷	10e ⁰⁷	10	4	ABS	Metal
	CTC022S-05P/08S	43,6	22	8	-	3	2	-	13	250	1000	2e ⁰⁷	10e ⁰⁷	10	4	ABS	Metal
	CTC022S-08P/08S	43,6	22	8	8	-	-	-	16	250	1000	2e ⁰⁷	10e ⁰⁷	10	4	ABS	Metal
CTC022S-06P/12S	43,6	22	12	6	-	-	-	18	250	1000	2e ⁰⁷	10e ⁰⁷	10	4	ABS	Metal	
CTC022S-03P/18S	43,6	22	18	3	-	-	-	21	250	1000	2e ⁰⁷	10e ⁰⁷	10	4	ABS	Metal	
CTC022S-00P/24S	43,6	22	24	-	-	-	-	24	250	1000	2e ⁰⁷	10e ⁰⁷	10	4	ABS	Metal	
CTC022S-00P/36S	57,3	22	36	-	-	-	-	36	250	1000	2e ⁰⁷	10e ⁰⁷	10	4	ABS	Metal	
CTC025S-00P/56S	85,7	25	56	-	-	-	-	56	250	1000	2e ⁰⁷	10e ⁰⁷	10	4	ABS	Metal	

SPECIFICATION

Specification	OD < 15,5mm		OD=15,5mm		OD > 15,5mm	
	Power	Signal	Power	Signal	Power	Signal
Rated Voltage	0~240 VAC/VDC	0~240 VAC/VDC	0~240 VAC/VDC	0~240 VAC/VDC	0~240 VAC/VDC	0~240 VAC/VDC
Insulation Resistance	≥600MΩ/500VDC		≥600MΩ/500VDC		≥600MΩ/500VDC	
Insulation Strength	500VAC@50Hz, 60s					
Lead Wires	AWG32#Teflon		AWG30#Teflon		AWG28#Teflon	
Lead Length	Standard 300mm (adjustable)					
Working Temperature	-30°C to 80°C					
Operating Humidity	0 ~ 85% RH					
Torque	0,05 Nm; +0,02 Nm/Grings		0,05 Nm; +0,02 Nm/Grings		0,05 Nm; +0,01 Nm/Grings	
Protection Grade	IP51					

RATING DATA

- CTC series slip rings are miniature with OD 12,5mm are small and compact with OD 22mm, with capsule style.
- Special designed for CCTV or small rotating system, OD 22mm and special fit for middle/small rotating system of transmitting low controlling signal.

- Circuits combination is available (such as video, control, sensor, power, Ethernet and so on)
- Lower torque low contact wear rates
- Support video, control, sensor, power, Ethernet signals

PART NUMBER

CTC 012S - xxP/yyS - 00000 - XXXXX

1 2 3 4 5 6 7 8 9

1 Inner Dia

2 Quality Level
S = Standard
I = Industrial

3 Number of power wires

4 Number of signal wires

5 Flange
00
01
..07

6 Flange Position
O = No Flange
R = Rotor
I = Interior
S = Stator

7 Rotor cable length
0 = 300mm
1 = 600mm
2 = 1200mm
X = Custom

8 Stator cable length
0 = 300mm
1 = 600mm
2 = 1200mm
X = Custom

9 Special Options
01CAN = CanOpen
01ECT= Ethercat
01PRO = Profibus
01ETH = Giga Ethernet
IP65 = IP65
IP68 = IP68



IP51
[standard]



Voltage
240 VDC/VAC



Current
1A to 15A



Working Temperature
-30°C to 80°C



Max speed
1000 RPM

FLANGES

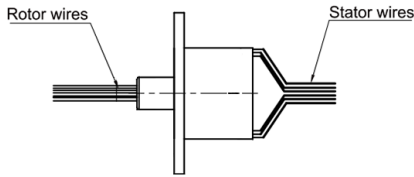

R

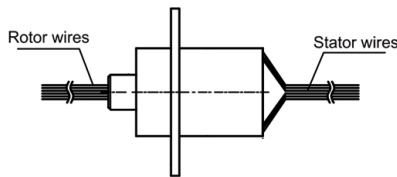

I

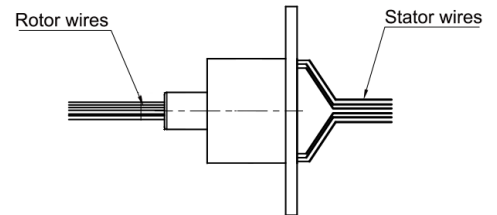

S

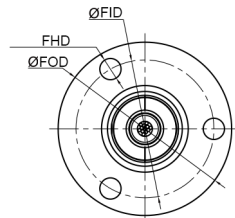

FLANGE	FOD	FID	ØFHD
00	0	0	0
01	22,5	17,5	3xØ3,2
02	24	18	3xØ3,2
03	29	22	3xØ4
04	32	25	3xØ2,8
05	32	27	3xØ3
06	39	29	3xØ3,5
07	44	35	3xØ5,4

	FLANGES OPTIONS																					
	No (00)	22,5x17,5 (01)			24x18 (02)			29x22 (03)			32x25 (04)			32x27 (05)			39x29 (06)			44x35 (07)		
		R	I	S	R	I	S	R	I	S	R	I	S	R	I	S	R	I	S	R	I	S
CTC005-4	■	-	-	-	-	-	-	-	-	-	-	-	-	-	-	-	-	-	-	-	-	-
CTC005-8	■	-	-	-	-	-	-	-	-	-	-	-	-	-	-	-	-	-	-	-	-	-
CTC006-8	■	-	-	-	-	-	-	-	-	-	-	-	-	-	-	-	-	-	-	-	-	-
CTC011-6	■	-	-	-	-	-	-	-	-	-	-	-	-	-	-	-	-	-	-	-	-	-
CTC012-6	●	●	-	-	■	●	●	●	-	-	-	-	-	-	-	-	-	-	-	-	-	-
CTC012-12	●	-	-	-	-	■	-	-	-	-	-	-	-	-	-	-	-	-	-	-	-	-
CTC012-18	●	-	-	-	-	-	-	-	-	-	-	-	-	-	-	-	-	-	-	-	-	-
CTC015-24	●	-	-	-	-	-	-	-	-	■	-	-	-	-	-	-	-	-	-	-	-	-
CTC-022-6	●	-	-	-	-	-	-	-	-	-	-	-	●	-	-	-	●	-	-	●	■	●
CTC022-12	●	-	-	-	-	-	-	-	-	-	-	-	●	-	-	-	●	-	-	●	■	●
CTC022-18	-	-	-	-	-	-	-	-	-	-	-	-	-	-	-	-	-	-	-	-	■	-
CTC022-24	-	-	-	-	-	-	-	-	-	-	-	-	-	-	-	-	-	-	-	-	■	-
CTC022-36	-	-	-	-	-	-	-	-	-	-	-	-	-	-	-	-	-	-	-	-	■	-
CTC025-56	-	-	-	-	-	-	-	-	-	-	-	-	-	-	-	-	-	-	-	-	■	-

■ STANDARD FEATURE ● OPTION - OPTION NOT AVAILABLE

In accordance with our policy of continual product improvement, A2V reserves the right to amend the specification of these products without prior notification